

Block of the Month

November 2011

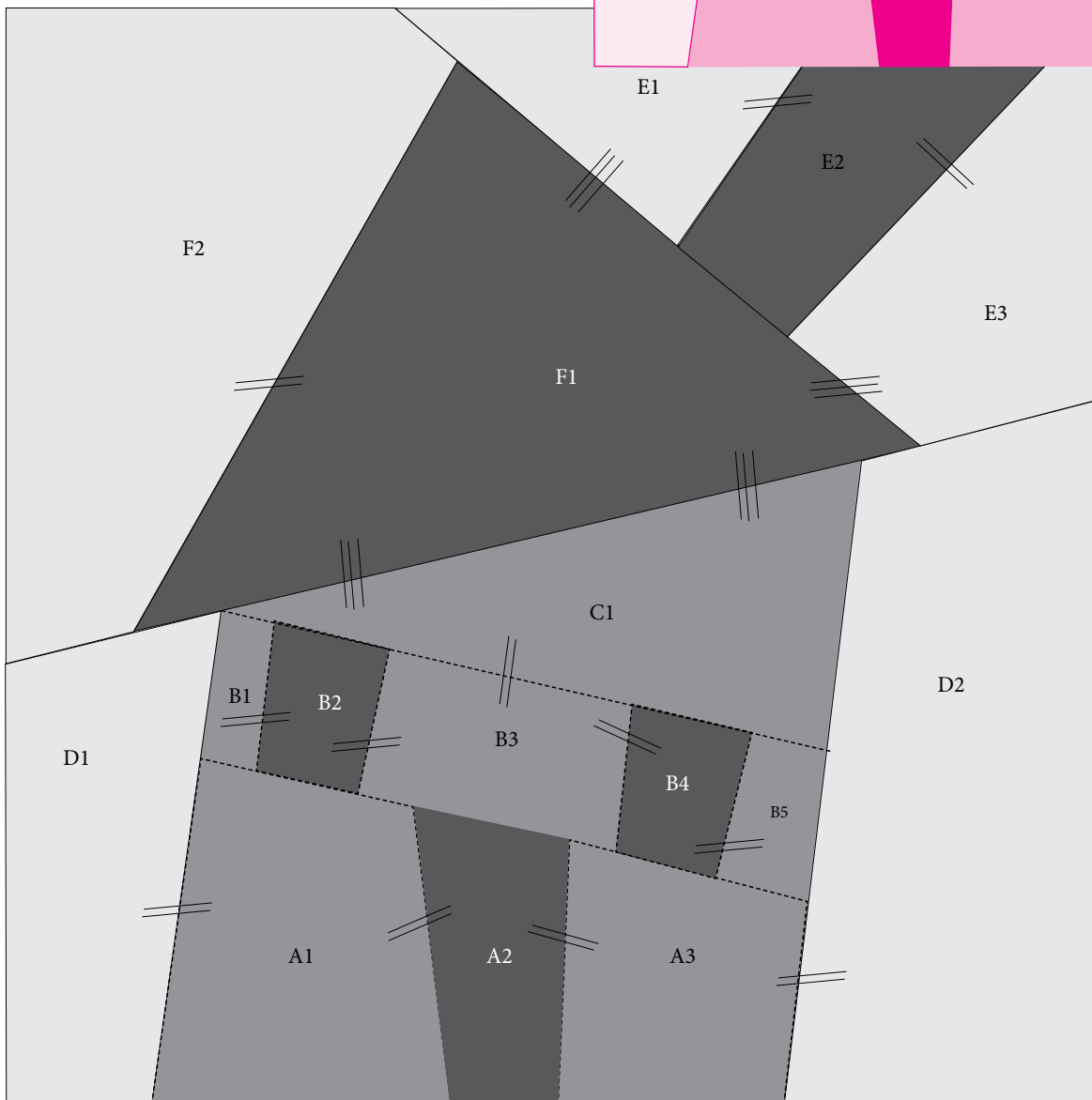

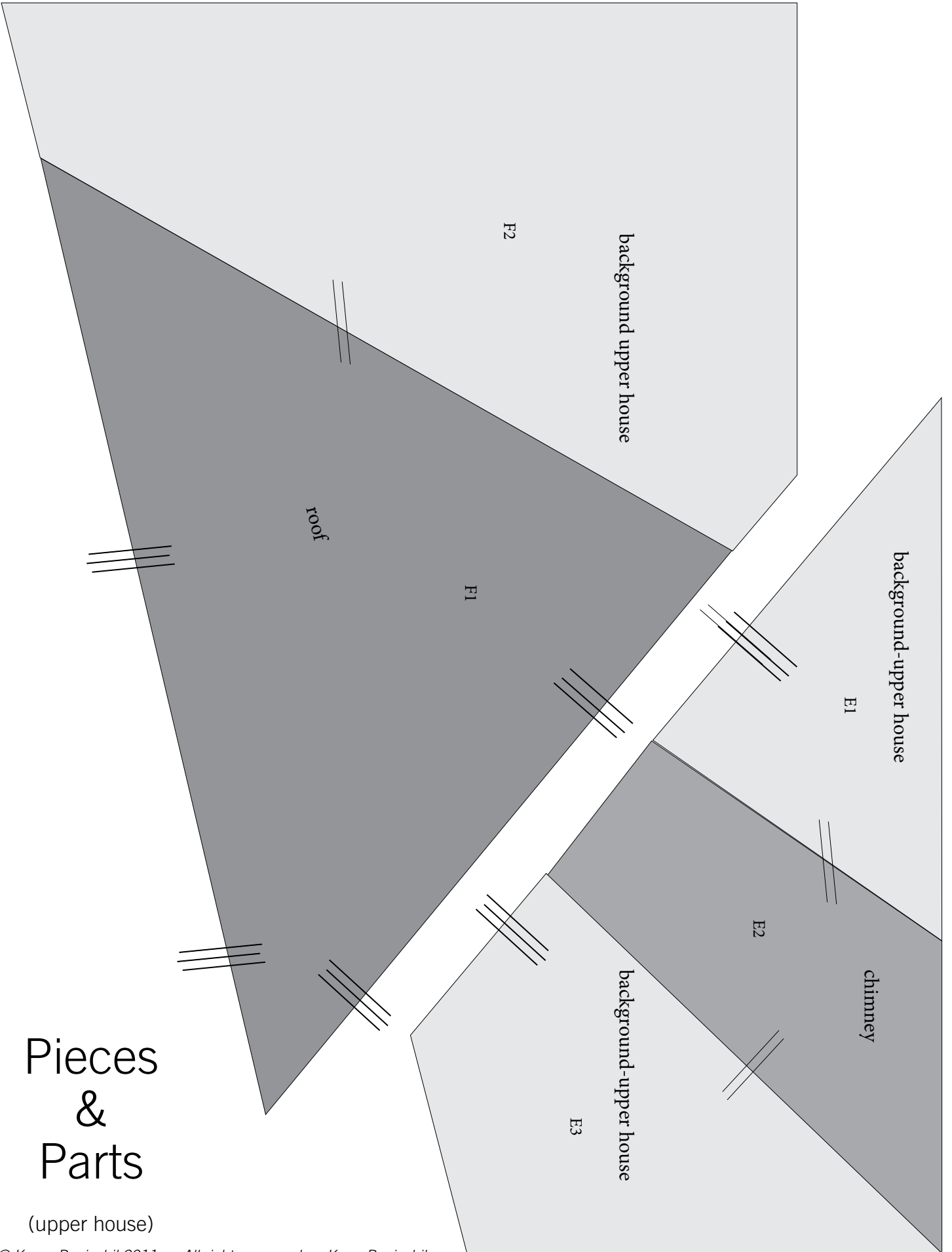

Pieces & Parts

(upper house)

Pieces & Parts

(lower house)

- Materials for pieced house block
- scraps of pinks & reds for house blocks
 - freezer paper

Directions

- using freezer paper, trace house shapes on to paper, be sure to include matching lines and numbers.
- iron freezer paper shapes to fabric
- add 1/4" seam allowance to all edges/sides of freezer paper
- stitching instructions (lower house)
 - stitch A1 to A2, A2 to A3
 - stitch B1 to B2, B2 to B3, B3 to B4
 - stitch A unit to B unit and B unit to C unit
 - stitch D1 & D2 to sides

- now stitch E1 to E2, E2 to E3 (chimney)
- next stitch F1 to F2 (roof and background)
- then stitch E unit to the F unit (background to chimney)
- now stitch E & F unit to C unit (roof/chimney to lower house)
- square up to 10.5x10.5
- Voilà ~ a funky house
- embellish as desired

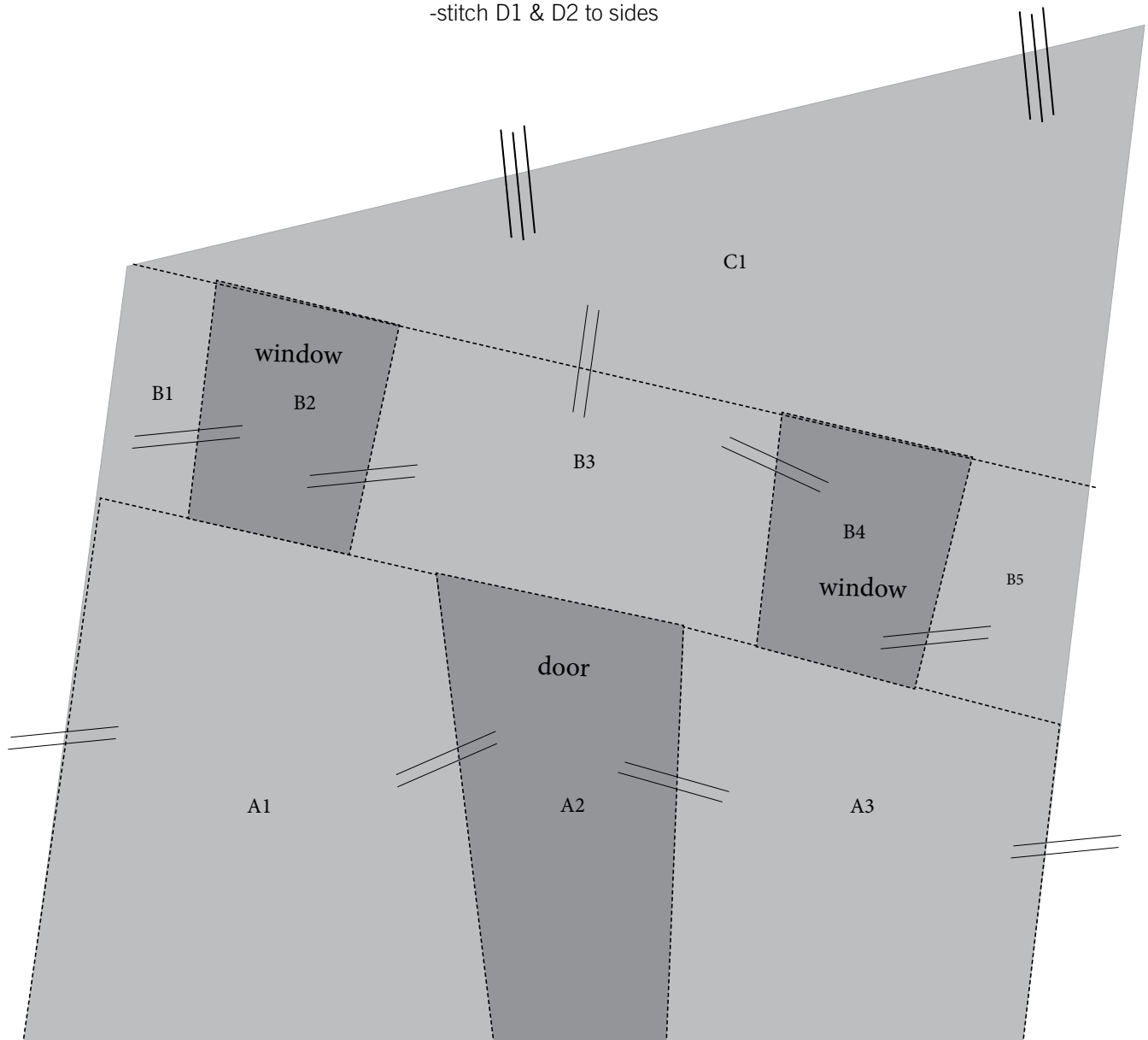

Pieces & Parts

(sides of lower house)

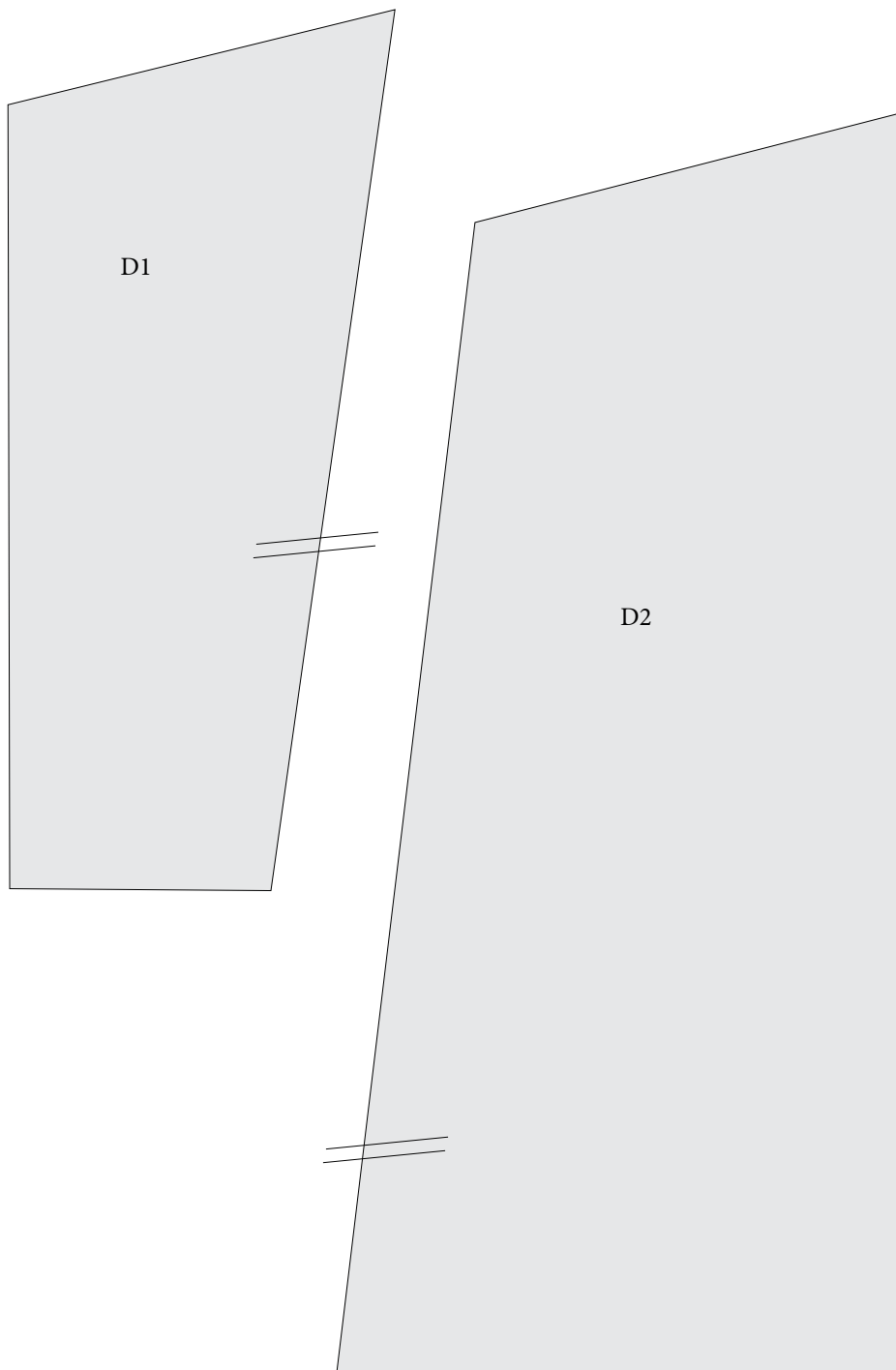

Materials for pieced house block

- scraps of pinks & reds for house blocks
- freezer paper

Directions

- using freezer paper, trace house shapes on to paper, be sure to include matching lines and numbers.
- iron freezer paper shapes to fabric
- add 1/4" seam allowance to all edges/sides of freezer paper
- stitching instructions (lower house)
 - stitch A1 to A2, A2 to A3
 - stitch B1 to B2, B2 to B3, B3 to B4
 - stitch A unit to B unit and B unit to C unit
 - stitch D1 & D2 to sides
- now stitch E1 to E2, E2 to E3 (chimney)
- next stitch F1 to F2 (roof and background)
- then stitch E unit to the F unit (background to chimney)
- now stitch E & F unit to C unit (roof/chimney to lower house)
- square up to 10.5x10.5
- Voilà ~ a funky house
- embellish as desired